

PANEL MOUNTING  
DIAL CASE HOLES:  
Use Two 1/4" (6.3mm)  
Screws

DRILL TWO MOUNTING  
HOSE IN PANEL:  
3/16" (4.7mm)

STANDARD MOUNT  
MOUNTING BRACKET:  
Two 5/16" (7.8mm)  
Mounting Holes

**DIAL SIZES:** 6" (152mm)  
8.5" (216mm)  
12" (305mm)  
18" (457mm)

**OPTIONS:**

- 4-20mA Transmitter (Model MA420), loop powered (requires 12-45 Volt DC power)
- Adjustable Low Level Alarm (Model RS5) with 10 amp manual reset relay (for Portable Tank Applications)
- Fixed Pressure Switch (Model PS10) 10 amp 110 or 220 Volt AC. (for Fixed Tank Applications)
- Locking Tare Adjust Knob (prevents tampering).

**SPECIFICATIONS:**

- Temperature Stable with damper installed to prevent shock damage.
- Accuracy shall be better than 1/2 of 1%.
- 5 Year Factory Warranty.
- Immune to power failure, lightning strikes & RFI/EMI.

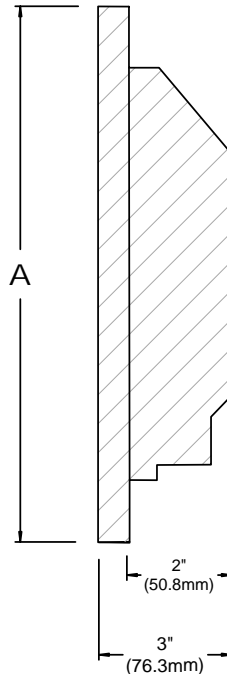
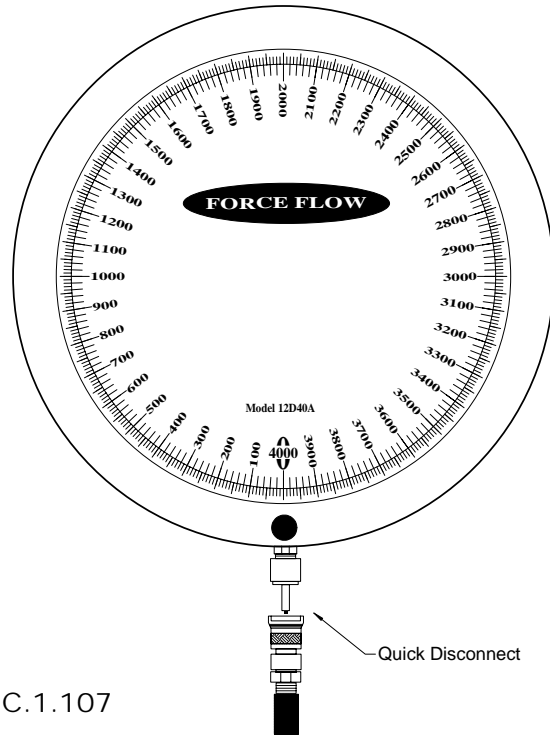

DIAL SIZE	DIAL OUTER DIAMETER	STANDARD MOUNT Mounting Bracket Hole Spacing	PANEL MOUNT Radius to Mounting Hole	PANEL MOUNT Cutout Diameter
	A	B	C	D
6" (152mm)	8 5/8" (219mm)	7 1/2" (191mm)	4 1/32" (102mm)	7 4/5" (200mm)
8 1/2" (216mm)	11 1/2" (292mm)	7 1/2" (191mm)	5 11/32" (136mm)	10 3/8" (264mm)
12" (305mm)	15" (381mm)	10 1/8" (257mm)	7 3/16" (183mm)	13 13/16" (351mm)
18" (457mm)	21 3/4" (552mm)	13 3/4" (349mm)	10 3/8" (264mm)	20" (508mm)

C.1.107



1150-D Burnett Ave, Concord, CA 94520 USA  
1-800-893-6723 US & Canada, Fax: 925-686-6713  
www.forceflow.com / info@forceflow.com

CENTURY  
HYDRAULIC INDICATORS

Drawn by: SLP  
Date: 09/01/95  
Revised: 10/10/05 DN  
Scale: NONE

Drawing Number  
**30196**